



WeatherMaker® Commercial Packaged Rooftops 3 to 27.5 Ton

UP TO
28%
LIGHTER



* Shown with optional economizer and louvered hail guards.

Turn to the Experts
Truly a leader in innovation, Carrier was the first company to utilize environmentally sound Puron® refrigerant in HVAC units. Without depleting the ozone layer, Puron refrigerant delivers ideal indoor air quality. Today over 2.5 million homes and businesses operate on Puron refrigerant-based HVAC systems. And as emphasis on environmental sensitivity continues to increase, Puron refrigerant will only become more relevant. Puron refrigerant is the refrigerant of the future.



Carrier's RTU Open controller continuously monitors and regulates constant volume rooftop operation with reliability and precision. This advanced controller features a sophisticated, factory-engineered control algorithm that provides optimum performance and energy efficiency. The RTU Open controller also features plug-and-play connectivity to Carrier's i-Vu® Open Control System. The i-Vu Open Control System combines state-of-the-art Carrier equipment, plug-and-play controllers, and the powerful, web-based i-Vu user interface to form a cohesive, intuitive, and fully integrated building automation system (BAS).

For added flexibility, Carrier's RTU Open controller is capable of stand-alone operation. Or, it can be integrated with any BAS utilizing the BACnet®, Modbus®, Johnson Controls® N2 or LonWorks® protocols.

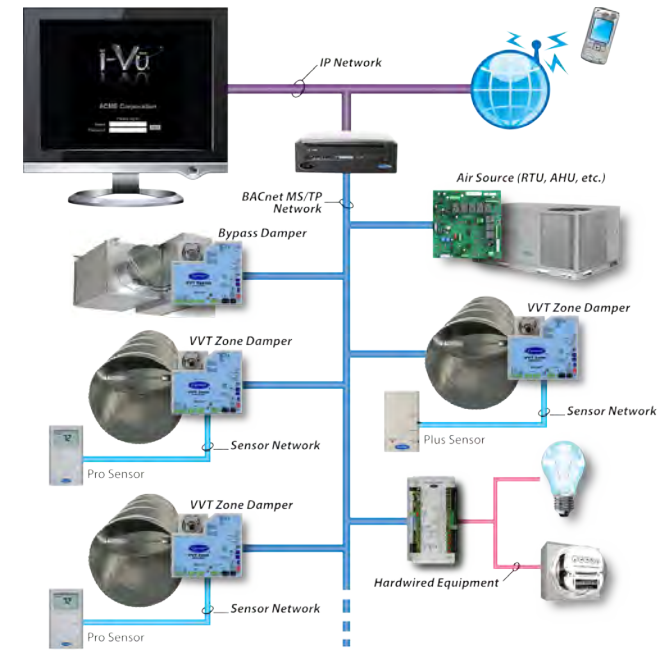

BACnet® is a registered trademark of American Society of Heating, Refrigerating and Air-Conditioning Engineers (ASHRAE).
MODBUS is a registered trademark of Gould Inc.
LONWORKS is a registered trademark of Echelon Corp.

The Future of the World Depends on Our Ability... to Sustain it.

As the world's leader in high technology heating, air-conditioning and refrigeration solutions, we believe that market leadership requires environmental leadership. Carrier sets industry standards for environmentally sound business practices and a commitment to sustainability across its products, services and operations. We demonstrate this commitment by creating environmentally responsible solutions that consume less energy and incorporate innovations that improve the world – indoors and out.



1-800-CARRIER www.carrier.com

Carrier Corporation ©2011
A member of the United Technologies Corporation family.
Stock symbol UTX. Cat. no. 18-848-169-25
Manufacturer reserves the right to discontinue, or change at any time, specifications or designs, without notice and without incurring obligations.





WeatherMaker[®] Commercial Packaged Rooftops



Easy to Install, Operate and Service

Designed with streamlined installation in mind, Carrier[®] WeatherMaker[®] rooftops have everything you need from handled access doors to certified and pre-engineered factory installed options and field installed accessories. Most Carrier rooftops are also designed with the same roof curb footprint to fit on older models dating back over 20 years.

Factory and field stocked, WeatherMaker units are available in gas heating/electric cooling, electric heat/electric cooling or packaged heat pumps and deliver SEERs as high as 13.4 and EERs up to 11.3. WeatherMaker rooftops have the capability for vertical or horizontal air flow for fast and easy installation. High-efficiency gas heating (up to 82% efficiency) with induced draft design facilitates long life and safe operation. Carrier WeatherMaker rooftops can satisfy nearly any light commercial application need.

Scroll Compressors

Each WeatherMaker unit utilizes a fully hermetic scroll compressor. Compressors are designed with internal isolation and have internal thermal line break, current overload and high pressure differential protection.



Central Terminal Board

Standard on every unit, the integrated terminal simplifies the installation of pre-engineered and certified field installed accessories, including economizers, by providing clearly labeled connection points for easy plug in connection.

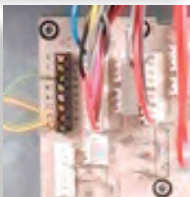

Easy-Access Handles

Handles located on all major access panels provide quick, convenient and safe access to components for easy maintenance and service.



No-Strip Screw Collars

To prevent misalignment and stripped metal panels, screws are guided into collars. This increased screw engagement also makes panels easier to remove and replace.

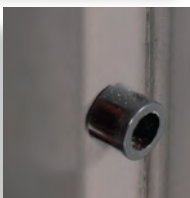

Unit Safety Protection

For increased reliability, heat pump models come standard with a refrigerant suction line accumulator in each refrigerant circuit. This preventive measure stops the natural tendency of liquid refrigerant from entering the compressor in heat pumps as they switch in and out of defrost, and between heating and cooling modes. In addition units come with high pressure and temperature protection as well as low pressure or loss of charge protection.



Comfort Control

Carrier's Humidi-MiZer[®] Adaptive Dehumidification system is an all-inclusive factory installed option on gas heating/electric cooling and electric heat/electric cooling models. This system provides reliable, flexible operation to meet indoor part load sensible and latent requirements.

Easy to Install

- WeatherMaker[®] rooftops were designed with streamlined installation in mind — whether it's for replacement or new construction.
- The light and compact design has full-perimeter base rails that help in moving, transporting and rigging.
- WeatherMaker models up to 12.5 tons are specifically designed to fit on Carrier similar roof curbs dating back over 20 years which makes replacement easy and eliminates the need for curb adapters or changing utility connections.
- Models are capable of either vertical or horizontal airflow capabilities to meet nearly every application need.

Gas Heating / Electric Cooling Models – 48TC

| Nominal Cooling Ton Size | Cooling Stages | AHRI Efficiency (SEER) EER | Dimensions (in) L x W x H | Gas Heat - Heating Input (MBUTH) | | | Approx. Unit Weight (lbs) |
|--------------------------|----------------|----------------------------|---------------------------|----------------------------------|--------|------|---------------------------|
| | | | | Low | Medium | High | |
| 3 | 1 | (13.0) | 74 x 47 x 33 | 72 | 115 | — | 483 |
| 4 | 1 | (13.0) | 74 x 47 x 33 | 72 | 115 | 150 | 537 |
| 5 | 1 | (13.0) | 74 x 47 x 33 | 72 | 115 | 150 | 569 |
| 6 | 1 | 11.0 | 74 x 47 x 41 | 72 | 115 | 150 | 652 |
| 7.5 | 1 | 11.0 | 88 x 59 x 41 | 125 | 180 | 224 | 780 |
| 7.5 | 2 | 11.0 | 88 x 59 x 41 | 125 | 180 | 224 | 835 |
| 8.5 | 1 | 11.0 | 88 x 59 x 49 | 125 | 180 | 224 | 920 |
| 8.5 | 2 | 11.0 | 88 x 59 x 49 | 125 | 180 | 224 | 930 |
| 10 | 1 | 11.0 | 88 x 59 x 49 | 180 | 224 | 250 | 930 |
| 10 | 2 | 11.1 | 88 x 59 x 49 | 180 | 224 | 250 | 940 |
| 12.5 | 2 | 10.8 | 88 x 59 x 49 | 180 | 224 | 250 | 1167 |
| 15 | 2 | 10.8 | 116 x 63 x 57 | 180 | 240 | 350 | 1380 |
| 15 | 2 | 10.8 | 128 x 87 x 49 | 220 | 310 | 400 | 1907 |
| 17.5 | 2 | 10.8 | 128 x 87 x 49 | 220 | 310 | 400 | 1922 |
| 20 | 2 | 9.8 | 141 x 87 x 49 | 220 | 310 | 400 | 2072 |
| 25 | 2 | 9.8 | 141 x 87 x 57 | 220 | 310 | 400 | 2197 |
| 27.5 | 2 | 10.2 | 158 x 87 x 57 | 220 | 310 | 400 | 2320 |

Electric Heat / Electric Cooling & Cooling Only Models – 50TC

| Nominal Cooling Ton Size | Cooling Stages | AHRI Efficiency (SEER) EER | Dimensions (in) L x W x H | Electrical Heat Nominal KW Range | Approx. Unit Weight (lbs) |
|--------------------------|----------------|----------------------------|---------------------------|----------------------------------|---------------------------|
| | | | | | |
| 4 | 1 | (13.0) | 74 x 47 x 33 | 4.4 to 23.0 | 494 |
| 5 | 1 | (13.0) | 74 x 47 x 33 | 6.5 to 26.5 | 524 |
| 6 | 1 | 11.2 | 74 x 47 x 41 | 6.0 to 26.5 | 607 |
| 7.5 | 1 | 11.2 | 88 x 59 x 41 | 10.0 to 42.4 | 705 |
| 7.5 | 2 | 11.2 | 88 x 59 x 41 | 10.0 to 42.4 | 760 |
| 8.5 | 1 | 11.2 | 88 x 59 x 49 | 10.4 to 42.4 | 845 |
| 8.5 | 2 | 11.2 | 88 x 59 x 49 | 10.4 to 42.4 | 855 |
| 10 | 1 | 11.2 | 88 x 59 x 49 | 10.0 to 51.0 | 855 |
| 10 | 2 | 11.3 | 88 x 59 x 49 | 10.0 to 51.0 | 865 |
| 12.5 | 2 | 11.0 | 88 x 59 x 49 | 10.0 to 51.0 | 1075 |
| 15 | 2 | 11.0 | 116 x 63 x 57 | 15.0 to 60.0 | 1305 |
| 15 | 2 | 11.0 | 128 x 87 x 49 | 25.0 to 75.0 | 1808 |
| 17.5 | 2 | 11.0 | 128 x 87 x 49 | 25.0 to 75.0 | 1823 |
| 20 | 2 | 10.0 | 141 x 87 x 49 | 25.0 to 75.0 | 1973 |
| 25 | 2 | 10.0 | 141 x 87 x 57 | 25.0 to 75.0 | 2098 |
| 27.5 | 2 | 10.4 | 158 x 87 x 57 | 25.0 to 75.0 | 2196 |

Packaged Heat Pump Models – 50TCQ

| Nominal Cooling Ton Size | Cooling Stages | AHRI Efficiency (SEER) EER | Dimensions (in) L x W x H | @ 47° F | | @ 17° F | | Approx. Unit Weight (lbs) |
|--------------------------|----------------|----------------------------|---------------------------|------------------|------------|------------------|------------|---------------------------|
| | | | | Heating Capacity | (HSPF) COP | Heating Capacity | (HSPF) COP | |
| 3 | 1 | (13.4) | 74 x 47 x 33 | 35,600 | (7.70) | 18,200 | (N/A) | 505 |
| 4 | 1 | (13.1) | 74 x 47 x 33 | 45,500 | (7.70) | 23,600 | (N/A) | 510 |
| 5 | 1 | (13.2) | 74 x 47 x 41 | 58,000 | (7.70) | 31,200 | (N/A) | 590 |
| 6 | 1 | 11.1 | 74 x 47 x 41 | 67,000 | 3.30 | 34,800 | 2.25 | 630 |
| 7.5 | 2 | 11.2 | 88 x 59 x 49 | 86,000 | 3.40 | 48,000 | 2.25 | 885 |
| 8.5 | 2 | 11.2 | 88 x 59 x 49 | 96,000 | 3.30 | 54,500 | 2.25 | 910 |
| 10 | 2 | 11.0 | 88 x 59 x 49 | 116,000 | 3.40 | 62,300 | 2.25 | 1050 |
| 12.5 | 2 | 10.6 | 116 x 63 x 57 | 142,000 | 3.20 | 76,000 | 2.05 | 1370 |
| 15 | 2 | 10.8 | 128 x 86 x 49 | 166,000 | 3.30 | 103,000 | 2.40 | 1775 |
| 20 | 2 | 10.5 | 141 x 86 x 49 | 220,000 | 3.30 | 134,000 | 2.30 | 2100 |

BACnet[®] is a registered trademark of American Society of Heating, Refrigerating and Air-Conditioning Engineers (ASHRAE).
 MODBUS is a registered trademark of Gould Inc.
 LONWORKS is a registered trademark of Echelon Corp.